



# Glowline - Inground

spec sheet

## Main Features

- Even, linear light appearance with ability to butt fittings together with uninterrupted light
- Curved lengths available
- Available in 38mm & 50mm widths
- Inground channel available for first fix
- 50 000+ hr lifetime expectancy
- IP65 or IP68

Glowline-Inground by The Light Lab



GL38 - Inground  
GL50 - Inground

# Product Details GL38-Inground



## Specification

	SO	HO
Length	Max length 1.5m	Max length 1.5m
Colour	3.0K/4.0K/5.0K	2.7K/3.0K/3.5K/4.0K/5.0K
Input Voltage	24Vdc	24Vdc
Power Consumption	9.6W/m	14W/m
Luminaire Efficiency	56 lm/W	78 lm/W
IP Rating	IP65 or IP68	IP65 or IP68

### Order code

GL38 INGROUND-LENGTH-OUTPUT-COLOUR-IP  
 e.g. GL38 INGROUND-XXmm-SO-2.27K-IP65

LENGTH	OUTPUT	COLOUR	IP
XXmm	SO	2.7K	IP65
	HO	3.0K	IP68
		3.5K	
		4.0K	
		5.0K	

### Drivers

non-dimmable power supplies:

1-10V /DALI/DMX dimmable power supplies to be ordered seperately

Please call our sales team who will make sure specification suits application

Glowline-Inground by The Light Lab



## Fixing Methods

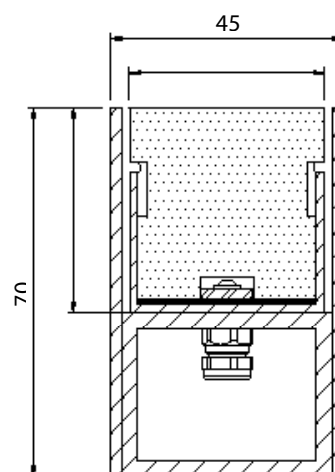

## Project Example

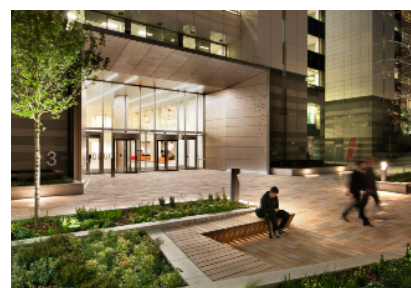

The Light Lab  
 22 Holywell Row  
 London EC2A 4JB  
 United Kingdom  
**+44 (0) 207 278 2678**  
**@thelightlabltd**  
**www.thelightlab.com**

# Product Details GL50-Inground



## Specification

	SO	HO
Length	Max length 1.5m	Max length 1.5m
Colour	3.0K/4.0K/5.0K	2.7K/3.0K/3.5K/ 4.0K/5.0K/
Input Voltage	24Vdc	24Vdc
Power Consumption	9.6W/m	14W/m
Luminaire Efficiency	56 lm/W	78 lm/W
IP Rating	IP65 or IP68	IP65 or IP68

### Order code

GL36 INGROUND-LENGTH-OUTPUT-COLOUR-IP  
e.g. GL36 INGROUND-XXmm-SO-2.27K-IP65

LENGTH	OUTPUT	COLOUR	IP
XXmm	SO	2.7K	IP65
	HO	3.0K	IP68
		3.5K	
		4.0K	
		5.0K	

### Drivers

non-dimmable power supplies:

1-10V /DALI/DMX dimmable power supplies to be ordered separately

Please call our sales team who will make sure specification suits application

Glowline-Inground by The Light Lab



## Fixing Methods

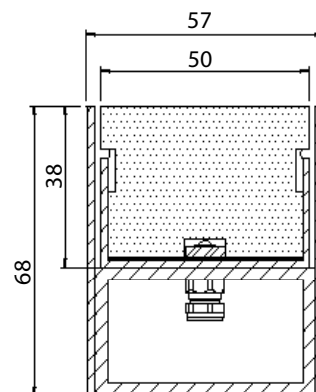

## Example Project

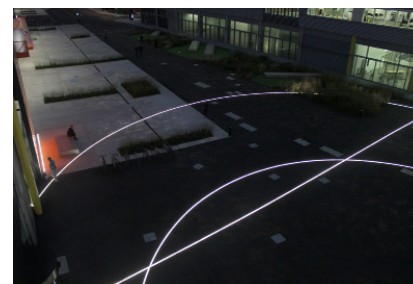

The Light Lab  
22 Holywell Row  
London EC2A 4JB  
United Kingdom  
**+44 (0) 207 278 2678**  
**@thelightlabltd**  
**www.thelightlab.com**

# Project Images



**Omagh Firestation, Ireland**

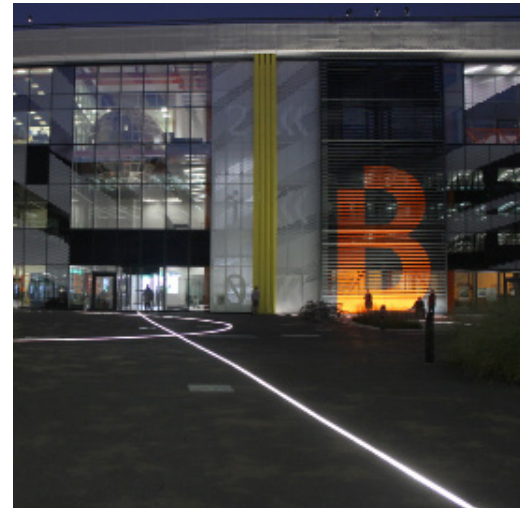

**Here East, Stratford**

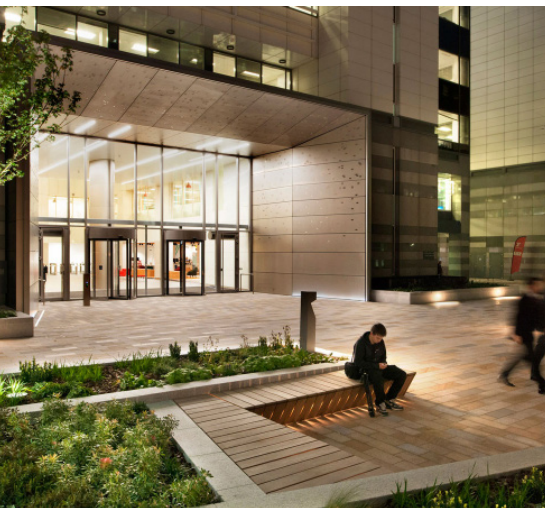

**Thomas More Square, London**



**Omagh Firestation, Ireland**

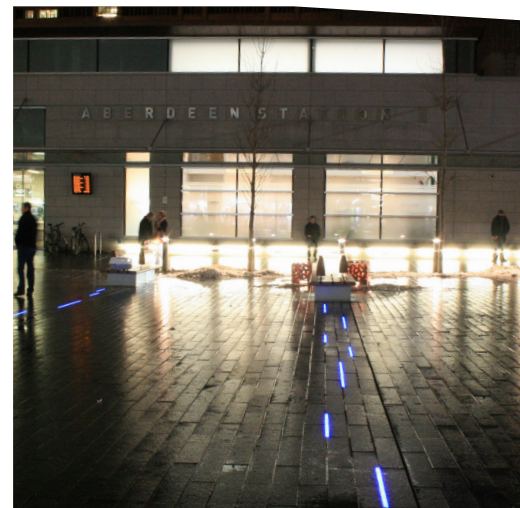

**Union Square, Aberdeen**



**Here East, Stratford**



**Thomas More Square, London**